

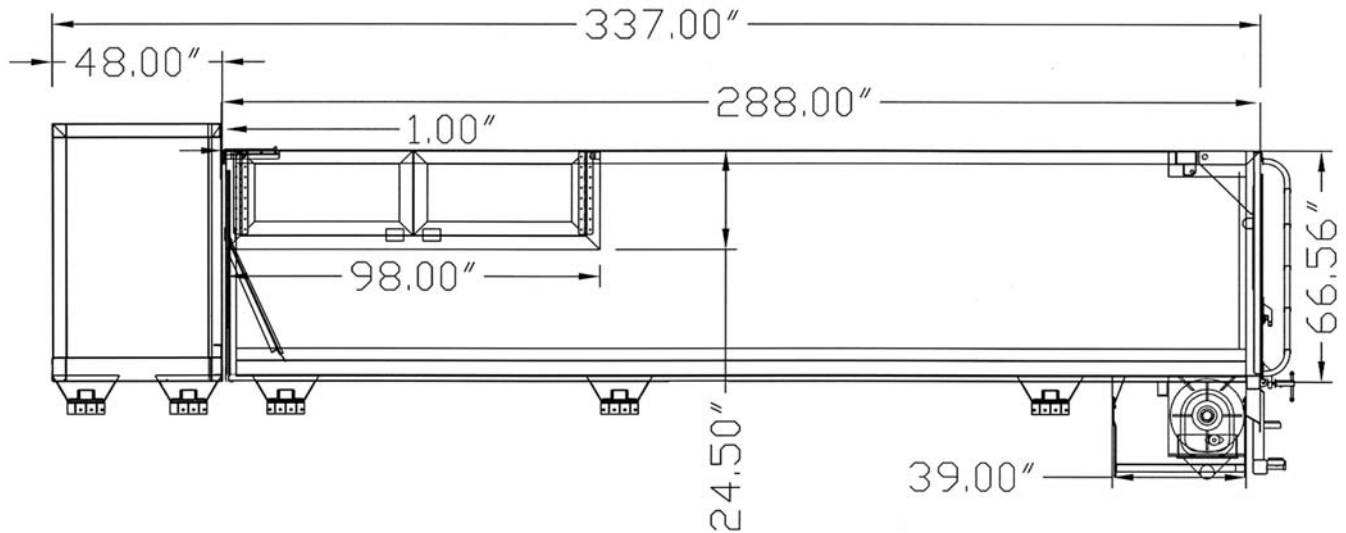

TM-30



Level Load Capacity: 30 Cubic Yards*
Empty Weight: Approximately 18,500 lbs.

Standards

Caterpillar 3126 Engine @ 275HP
Patented Feed System
Electronic Control Module (ECM)
Dual Drive Reversible Floor
Dust Suppression
Hydraulic Tailgate
Shur-Lock Roll Tarp
Safety Shutdown Systems
Shovel, Broom, & Pitchfork
Complete 4-Inch Hose Set: Approx. 286 Ft.
5 Ft. Heavy Duty 4-Inch Discharge Hose

Steel Framed Aluminum Box
Reversible Augers
Programmable Display
Remote Radio Control
Proportional Hydraulic System
Loading Doors
Factory Direct Training
Inspection Ladder

Options

Call an Express Blower Sales Representative for a complete list of options.

**Hauling yardage dependent upon weights of materials and local state laws.
Standards and options subject to change.*